



Lead cut and forming (Radial type)

Forming Method	Code	Shape	Dimensions																																																		
Forming Cut (4 ϕ ~8 ϕ)	FC		<table border="1"> <thead> <tr> <th>Dϕ</th> <th>dϕ</th> <th>F</th> <th>P</th> <th>l</th> </tr> </thead> <tbody> <tr><td>4</td><td>0.45</td><td>1.5</td><td>5.0</td><td>—</td></tr> <tr><td>5</td><td>0.5</td><td>2.0</td><td>5.0</td><td>—</td></tr> <tr><td>6.3</td><td>0.5</td><td>2.5</td><td>5.0</td><td>—</td></tr> <tr><td>8</td><td>0.6</td><td>3.5</td><td>5.0</td><td>—</td></tr> </tbody> </table>	D ϕ	d ϕ	F	P	l	4	0.45	1.5	5.0	—	5	0.5	2.0	5.0	—	6.3	0.5	2.5	5.0	—	8	0.6	3.5	5.0	—																									
			D ϕ	d ϕ	F	P	l																																														
4	0.45	1.5	5.0	—																																																	
5	0.5	2.0	5.0	—																																																	
6.3	0.5	2.5	5.0	—																																																	
8	0.6	3.5	5.0	—																																																	
Cut (4 ϕ ~22 ϕ)	CC		<table border="1"> <thead> <tr> <th>Dϕ</th> <th>dϕ</th> <th>F</th> <th>P</th> <th>l</th> </tr> </thead> <tbody> <tr><td>10</td><td>0.6</td><td>5.0</td><td>—</td><td>—</td></tr> <tr><td>12.5</td><td>0.6</td><td>5.0</td><td>—</td><td>—</td></tr> <tr><td>16</td><td>0.8</td><td>7.5</td><td>—</td><td>—</td></tr> <tr><td>18</td><td>0.8</td><td>7.5</td><td>—</td><td>—</td></tr> <tr><td>22</td><td>0.8</td><td>10.0</td><td>—</td><td>—</td></tr> </tbody> </table>	D ϕ	d ϕ	F	P	l	10	0.6	5.0	—	—	12.5	0.6	5.0	—	—	16	0.8	7.5	—	—	18	0.8	7.5	—	—	22	0.8	10.0	—	—																				
			D ϕ	d ϕ	F	P	l																																														
10	0.6	5.0	—	—																																																	
12.5	0.6	5.0	—	—																																																	
16	0.8	7.5	—	—																																																	
18	0.8	7.5	—	—																																																	
22	0.8	10.0	—	—																																																	
Snap-in Forming Cut (5 ϕ ~8 ϕ)	SF		<table border="1"> <thead> <tr> <th>Dϕ</th> <th>dϕ</th> <th>F</th> <th>P</th> <th>l</th> </tr> </thead> <tbody> <tr><td>4</td><td>0.45</td><td>1.5</td><td>5.0</td><td>—</td></tr> <tr><td>5</td><td>0.5</td><td>2.0</td><td>5.0</td><td>—</td></tr> <tr><td>6.3</td><td>0.5</td><td>2.5</td><td>5.0</td><td>—</td></tr> <tr><td>8</td><td>0.6</td><td>3.5</td><td>5.0</td><td>—</td></tr> <tr><td>10</td><td>0.6</td><td>5.0</td><td>—</td><td>—</td></tr> <tr><td>12.5</td><td>0.6</td><td>5.0</td><td>—</td><td>—</td></tr> <tr><td>16</td><td>0.8</td><td>7.5</td><td>—</td><td>—</td></tr> <tr><td>18</td><td>0.8</td><td>7.5</td><td>—</td><td>—</td></tr> <tr><td>22</td><td>0.8</td><td>10.0</td><td>—</td><td>—</td></tr> </tbody> </table>	D ϕ	d ϕ	F	P	l	4	0.45	1.5	5.0	—	5	0.5	2.0	5.0	—	6.3	0.5	2.5	5.0	—	8	0.6	3.5	5.0	—	10	0.6	5.0	—	—	12.5	0.6	5.0	—	—	16	0.8	7.5	—	—	18	0.8	7.5	—	—	22	0.8	10.0	—	—
			D ϕ	d ϕ	F	P	l																																														
4	0.45	1.5	5.0	—																																																	
5	0.5	2.0	5.0	—																																																	
6.3	0.5	2.5	5.0	—																																																	
8	0.6	3.5	5.0	—																																																	
10	0.6	5.0	—	—																																																	
12.5	0.6	5.0	—	—																																																	
16	0.8	7.5	—	—																																																	
18	0.8	7.5	—	—																																																	
22	0.8	10.0	—	—																																																	
Snap-in Cut (10 ϕ ~22 ϕ)	SC		<table border="1"> <thead> <tr> <th>Dϕ</th> <th>dϕ</th> <th>F</th> <th>P</th> <th>l</th> </tr> </thead> <tbody> <tr><td>10</td><td>0.6</td><td>5.0</td><td>—</td><td>—</td></tr> <tr><td>12.5</td><td>0.6</td><td>5.0</td><td>—</td><td>—</td></tr> <tr><td>16</td><td>0.8</td><td>7.5</td><td>—</td><td>—</td></tr> <tr><td>18</td><td>0.8</td><td>7.5</td><td>—</td><td>—</td></tr> <tr><td>22</td><td>0.8</td><td>10.0</td><td>—</td><td>—</td></tr> </tbody> </table>	D ϕ	d ϕ	F	P	l	10	0.6	5.0	—	—	12.5	0.6	5.0	—	—	16	0.8	7.5	—	—	18	0.8	7.5	—	—	22	0.8	10.0	—	—																				
			D ϕ	d ϕ	F	P	l																																														
10	0.6	5.0	—	—																																																	
12.5	0.6	5.0	—	—																																																	
16	0.8	7.5	—	—																																																	
18	0.8	7.5	—	—																																																	
22	0.8	10.0	—	—																																																	

Unit(mm)

Example of Part Number

RE 25V 100M	SF
	Lead Code

Radial lead taping

Available for capacitors with diameters of 4, 5, 6.3, 8 and 10 mm Unit(mm)

Symbol	Case Size			Tolerance	Remarks
	4 × 7 5 × 7 6.3 × 7	5 × 11 6.3 × 11	8 × 11.5		
dø	0.45	0.5		± 0.05	
P	12.7			± 10	
P ₀	12.7			± 0.2	
P ₁	3.85			± 0.7	
P ₂	6.35			± 1.0	
F	5.0			+0.8 -0.2	
ΔH	0			± 0.2	
W	18.0			± 0.5	
W ₀	12.5min				
W ₁	9.0			+0.75 -0.5	
W ₂	3.0max				
H	17.5	18.5	20.0	± 0.75	for Ammo Pack
H ₀	16.0			± 0.5	
H ₁	32.25max				for Reel Pack
ℓ	1.0max				
Døø	4.0			± 0.3	
t	0.7			± 0.2	
L	11.0max				

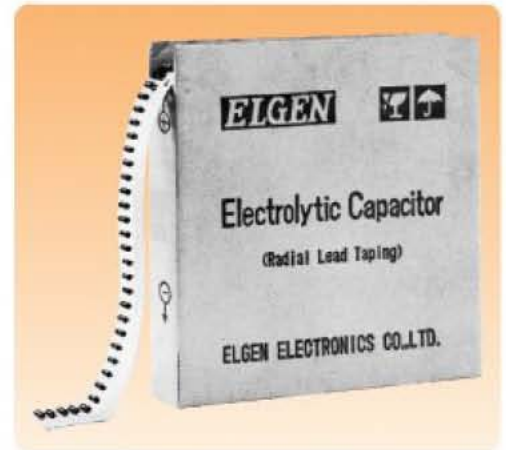

Symbol	Dø = 10	Tolerance
dø	0.6	± 0.05
P	12.7	± 10
P ₀	12.7	± 0.3
P ₁	3.85	± 0.7
P ₂	6.35	± 1.3
F	5.0	+0.8 -0.2
ΔH	0	± 2.0
W	18.0	± 0.5
W ₀	12.5min	
W ₁	9.0	+0.75 -0.5
W ₂	3.0max	
H	18.5	± 0.75
ℓ	1.0max	
Døø	4.0	± 0.3
t	0.7	± 0.2
L	11.0max	

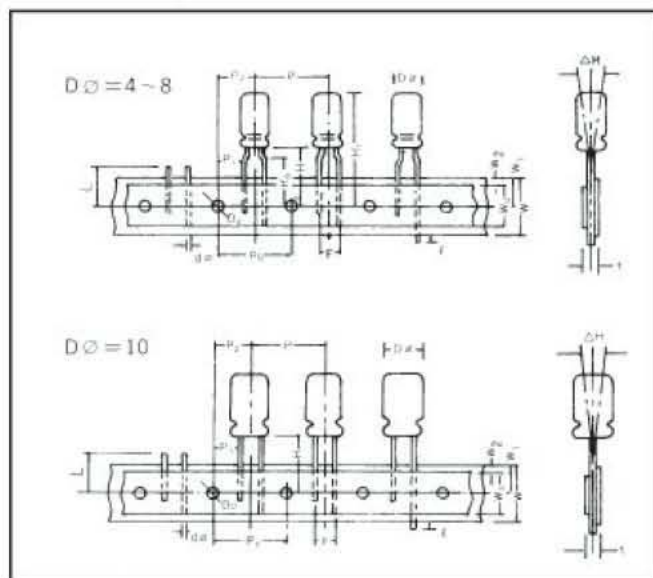

Pack 1. Reel pack

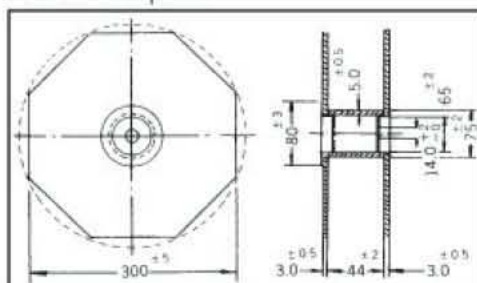

2. Ammo pack

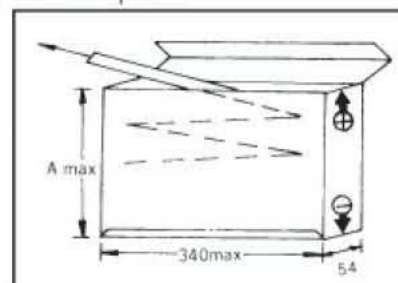

(mm)

Dø	Reel	Ammo	
	Quantity (pcs)	Quantity (pcs)	A
4	1800	2500	285
5	1500	2000	285
6.3	1000	2000	325
8	800	1000	285
10	600	800	325